

Model LX7740-ETN Outdoor LED Lacrosse Scoreboard

Cutsheet with Mechanical Detail

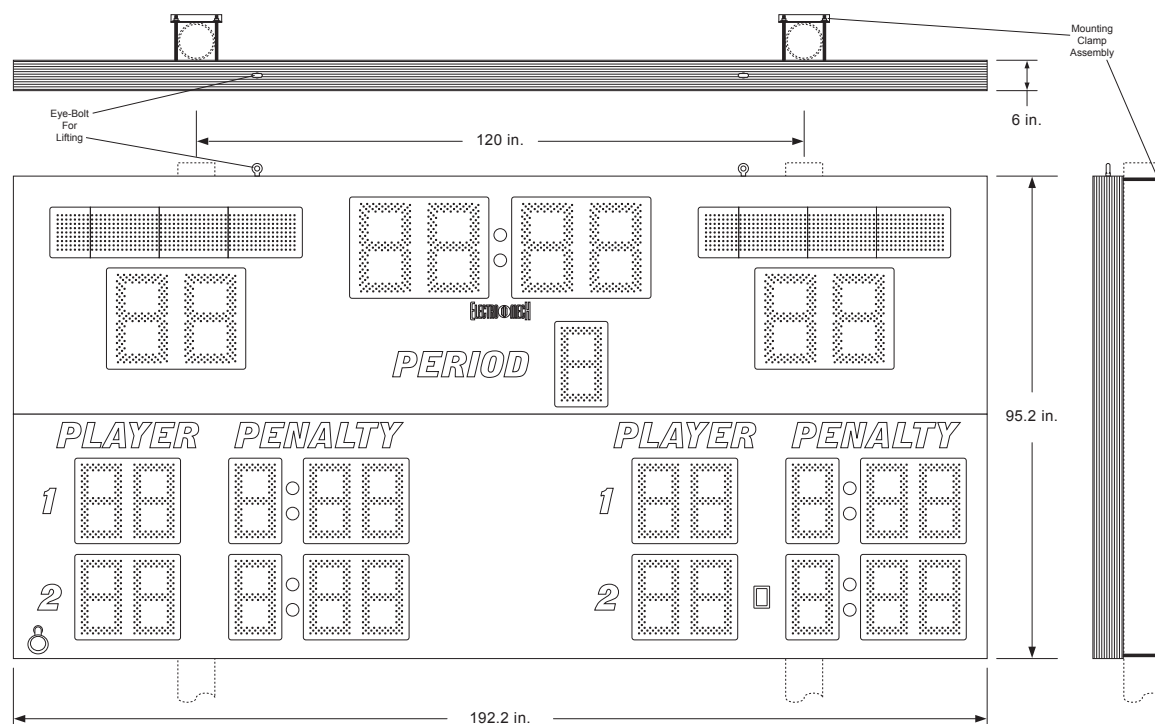

Cabinet Size, Weight:

16 ft. x 8 ft. x 6 in., 350 lbs.

Electrical Requirements:

6.7 Amps, 120 VAC

Display Sizes:

- 18 in. tall 4-Digit Game Clock
- 18 in. tall Guest Scores
- 18 in. tall Home Scores
- 15 in. tall Period
- 15 in. tall Home Player Number 1
- 15 in. tall Home Player Number 2
- 15 in. tall Guest Player Number 1
- 15 in. tall Guest Player Number 2
- 15 in. tall Home Penalty Clock 1
- 15 in. tall Home Penalty Clock 2
- 15 in. tall Guest Penalty Clock 1
- 15 in. tall Guest Penalty Clock 2
- 7 in. tall 9 x 56 pixel ETNs

Standard Post Sizes:

2 each, max diameter 7 in.

Standard Equipment & Features

- Double cabinet design with heavy duty extruded aluminum framing
- Light weight, rust free, all aluminum construction
- Mounting hardware for permanent installation on two posts without the need for on site fabrication
- Automotive grade baked on enamel based paint applied to the scoreboard face
- Choice of 18 standard paint colors
- Choice of amber or red LED displays
- Trumpet horn mounted internally
- LED display circuit boards conformal coated for outdoor use
- Full-sized 37-key control console with LCD display
- 50 levels of brightness selectable from the console to reduce glare at night
- Control console includes fully programmable Practice Segment Timer mode
- Junction box and patch cable for hardwired installations
- Five-year limited warranty
- Toll free technical support via phone and online for the life of the product

Optional Equipment & Features

- ID panels with custom graphics, in a variety of sizes, shapes and styles, to mount above, below, or beside the scoreboard
- Full color video and other electronic display panels
- Stadium Sound System packages
- Custom paint colors
- Up to 1,000 feet of data cable for hardwired installations
- ScoreLink Wireless RF modem system for wireless communication
- Additional warranty and support plans